

LED Light Fittings

HRD97 Series Explosion-proof LED Lightings



- ◆ Explosion protection to
 - CENELEC
 - IEC
 - NEC
- ◆ Can be used in
 - Zone 1 and Zone 2
 - Zone 21 and Zone 22
 - Class I, Zone 1 and Zone 2
 - Class I, Division 1, Groups A, B, C, D
- ◆ Applicable lamp and power (max.20W)
 - LED : 10W, 20W
- ◆ Isolated LED lamp compartment, CC-CV (constant current - constant voltage) power controller compartment and terminal compartment; Wind-convection heat dissipation structure
- ◆ Low-maintenance costs due to long service life, which is up to 100,000 operating hours.

Catalogue number logic

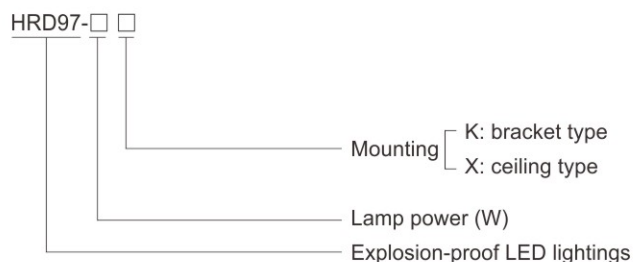

Selection table

Type / Ordering code	Lamp power(W)
HRD97-10 □	10
HRD97-20 □	20

Note: 1. Products above include all the mounting accessories listed in Mounting Accessories & Spare Parts Table (see P2/69).
2. The product is supplied according to "Type/Ordering code" in the table with mounting accessories.

Zones 1&2; 21&22

LED Light Fittings

HRD97 Series Explosion-proof LED Lightings

Technical data

Explosion-proof LED lightings HRD97-□□

Explosion protection

Global (IECEX)

IECEX CQM 22.0036X

Gas and dust

Ex db IIC T6 Gb

Ex tb IIIC T80°C Db

Europe (ATEX)

UL 23 ATEX 3016X

Gas and dust

Ex II 2 G Ex db IIC T6 Gb

Ex II 2 D Ex tb IIIC T80°C Db

Certificates

IECEX; ATEX

Conformity to standards

EN 60079-0, EN 60079-1, EN 60079-31

IEC 60079-0, IEC 60079-1, IEC 60079-31

Material

Enclosure

Copper-free aluminium alloy, powder coated surface, yellow (RAL1021)

Transparent cover

Toughened glass, stands 4J impact

Exposed fastener

Stainless steel

LED driver

Wide voltage input, CC-CV (constant current - constant voltage) output, power factor ≥ 0.95 , with function of distributed current, constant current, surge-proof and anti-electromagnetic interference, and protection against overcurrent, open circuit, and short circuit

Lamp

Lamp specification

Integrated LED, Multiple LED

Lamp power (W)

10W, 20W

Colour rendering index (Ra)

≥ 80

Colour temperature (CCT)

5700K

Note: cool white is available in general. Warm white or nature white is optional, please specify when ordering.

Rated voltage

24V AC 50/60Hz, 36V AC 50/60Hz, 100~277V AC 50/60Hz, 24V DC, 36V DC

Earthing protection

M5 (internal & external earth bolts)

Degree of protection

IP66

Ambient temperature

-40°C~+60°C

Terminal

3 x 1.5~4mm² (L+N+PE)

Mounting

Bracket type, Ceiling type

Cable entries

M25 x 1.5

Cable gland

See Mounting Accessories & Spare Parts Table

Available cable outer diameter

$\Phi 10 \sim \Phi 14$ (mm)



Dimension drawings (all dimensions in mm) - subject to alteration

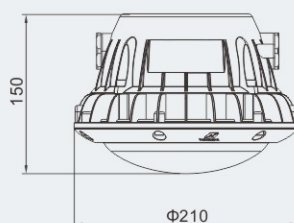

LED Light Fittings

HRD97 Series Explosion-proof LED Lightings

Photometric data Note: LED luminous flux is from the standard product of which colour temperature is 5700K



HRD97-10□

Lamp power (W)	Luminous flux	Wattage
10	1200lm	10W

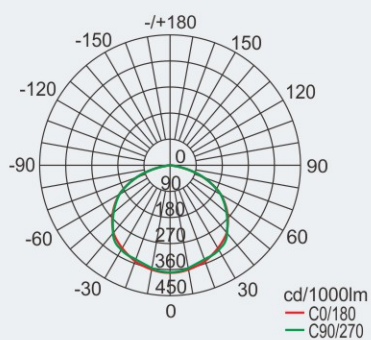

HRD97-20□

Lamp power (W)	Luminous flux	Wattage
20	2500lm	20W

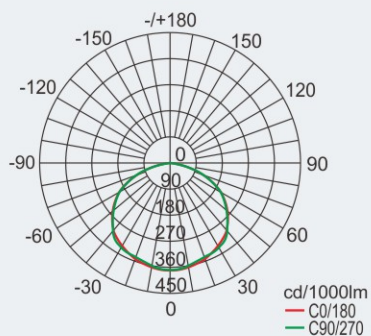

We can provide lighting design and data by professional lighting software DIALUX based upon simulated site situation on request.

LED Light Fittings

HRD97 Series Explosion-proof LED Lightings

Mounting type (all dimensions in mm) - subject to alteration

X: ceiling type

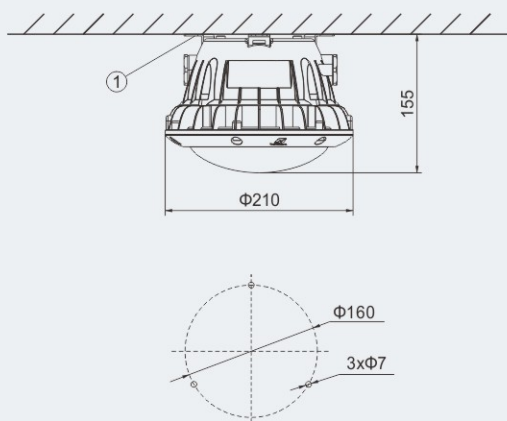

Weight: 3.30kg

Accessories supplied with the light fittings:

①. Mounting feet

K: bracket type

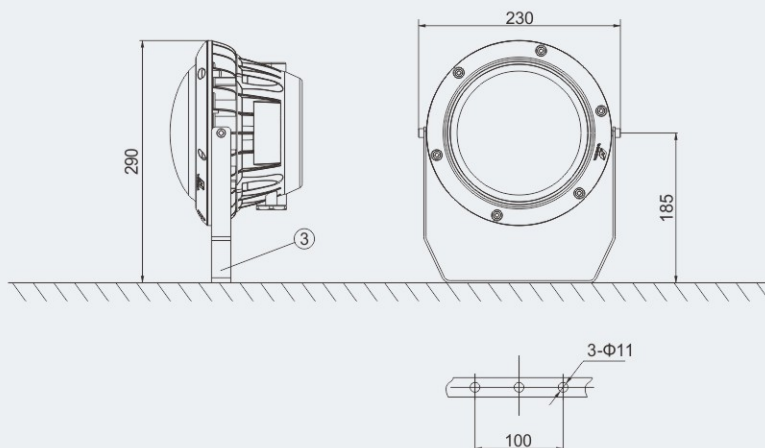

Weight: 3.80kg

Accessories supplied with the light fittings:

③. Wall bracket

