

## LED Light Fittings

### HRD97 Series Explosion-proof LED Lightings

**Mounting type** (all dimensions in mm) - subject to alteration

X: ceiling type

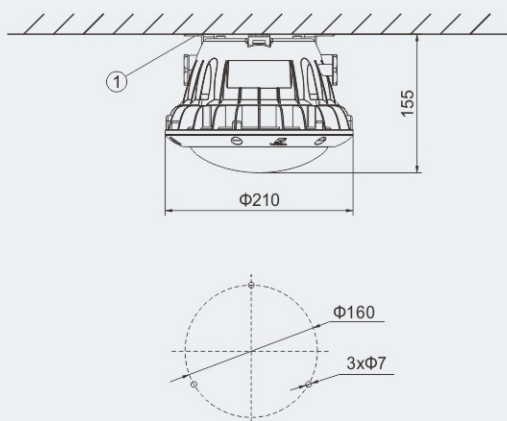

Weight: 3.30kg

Accessories supplied with the light fittings:

①. Mounting feet

K: bracket type

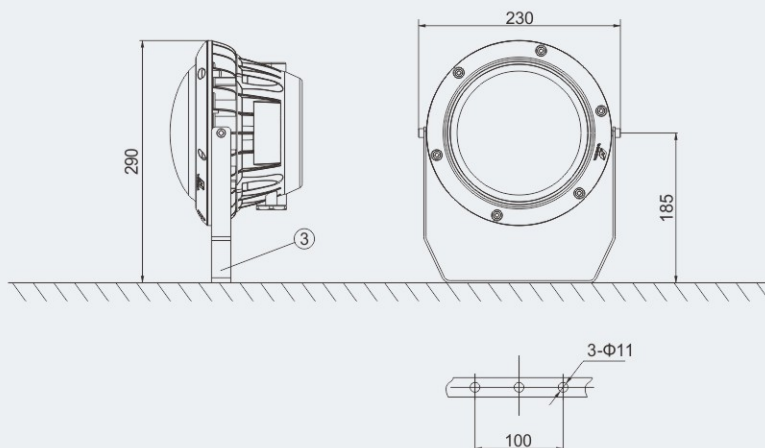

Weight: 3.80kg

Accessories supplied with the light fittings:

③. Wall bracket

